

# BROADGATE PARK

## STUDENT ARRIVAL GUIDE 21/22



DOWNLOAD  
OUR APP

home at halls

**BROADGATE PARK**  
The place to be

+44 (0)115 951 8670  
[broadgatepark@upp-ltd.com](mailto:broadgatepark@upp-ltd.com)



University of  
Nottingham  
UK | CHINA | MALAYSIA

in  
partnership  
with



# YOUR CHECKLIST

## REGISTER AT THE UNIVERSITY OF NOTTINGHAM

Click here to complete your online pre-registration.

Please follow University guidance on registering.

## DOWNLOAD THE SU APP NOW

You'll find the most up-to-date information for all Welcome events, campus maps so you never feel lost, useful contacts if you need support and information about upcoming elections. Suitable for both Apple and android devices.

## PARCEL LOCKERS AMAZON

We have an Amazon locker onsite - add this to your Amazon address book. The name of the locker is 'Vine'.

### UniDrop LOCKER

All couriers are directed to use this if they are unable to get in touch with you whilst on site. Speak to Reception for more information.

## COMPLETE THE E-INDUCTION

You will be invited to complete your online induction prior to your arrival. This will only take around 10 mins and will provide you with important information about life at Broadgate Park.

Please ensure that you choose your arrival slot once this has been complete.

## WI-FI

Our internet is provided by Glide. We advise that you register for the internet access prior to your arrival. Click your hall below.

**BROADGATE**

**ALBION HOUSE**

**CLOISTER HOUSE**

## ENDSLEIGH INSURANCE

Included in your rent is basic contents insurance, please check the cover is adequate for all of your personal items.

You can check your cover here and search UPP (Broadgate Park)

# PAYMENTS AND KEY DATES

Term 1 and deposit due  
**7th Sept 21**

Term 2 due  
**17th Jan 22**

Term 3 due  
**16th May 22**

All payments must be made direct to the University via your [MyNottingham portal](#) or by bank transfer using the information given in this link - [University payment information](#)

If you are reliant upon a UK student loan please note that your damage deposit of £250.00 plus a £250.00 rent pre-payment must be paid by 7th September 2021.

Please [email us](#) to confirm when you have made payments towards your rent and deposit.

## LICENCE DATES

**Undergraduates - 17th September 2021\* - 22nd July 2022**

\*Arrival slots may vary to this date

**Postgraduates - 17th September 2021\* - 9th September 2022**

\*Arrival slots may vary to this date

**Semester 1 - 18th September 2021\* - 21st January 2022**

\*Arrival slots may vary to this date

**Semester 2 - 23rd January 2022 - 18th June 2022**

# YOUR ROOM

## STANDARD BEDROOM/ LARGE STANDARD BEDROOM

### Items in the bedroom

Bed  
Curtains  
Wardrobe  
Desk & Chair  
Wi-Fi & Data Point  
Mirror

### Items in the communal space

Toaster  
Fridge  
Freezer  
Iron & Board  
Hob  
Microwave

**\*Corridor,  
kitchen and  
bathroom  
cleaned once  
a week**

Standard Bedroom - Single bed (Approx. 90 x 190 cm)

Large Standard Bedroom - Small double bed (Approx. 120 x 190 cm)

Take a tour of our Standard Bedroom Flat

## ENSUITE BEDROOM/ LARGE ENSUITE BEDROOM

### Items in the bedroom

Bed  
Curtains  
Wardrobe  
Desk & Chair  
Wi-Fi & Data Point  
Mirror

### Items in the communal space

Toaster  
Fridge  
Freezer  
Iron & Board  
Hob  
Microwave

**\*Corridor  
and kitchen  
cleaned once  
a week**

Ensuite Bedroom - Single bed (Approx. 90 x 190 cm)

Large Ensuite Bedroom - Small double bed (Approx. 120 x 190 cm)

Take a tour of our Ensuite Flat

\*Cleaning in line with Government guidelines. Subject to change.

# YOUR ROOM

## ENSUITE STUDIO/ LARGE ENSUITE STUDIO

Bed  
Curtains  
Wardrobe  
Desk & Chair  
Wi-Fi & Data Point  
Mirror  
Kettle

Fridge with chiller compartment  
Hob  
Microwave combination oven  
Dedicated ironing room (within the block)

**\*Corridor  
cleaned once  
a week**

Ensuite Studio - Single bed (Approx. 90 x 190 cm)

Large Ensuite Studio -  
Small double bed (Approx. 120 x 190 cm)

Take a tour of our Ensuite Studio Flat

## TWIN ENSUITE STUDIO/ LARGE TWIN ENSUITE STUDIO

Bed  
Curtains  
Wardrobe  
Desk & Chair  
Wi-Fi & Data Point  
Mirror  
Kettle

Fridge with chiller compartment  
Hob  
Microwave combination oven  
Dedicated ironing room (within the block)

**\*Corridor  
cleaned once  
a week**

Twin Ensuite Studio -  
2x Single bed (Approx. 90 x 190cm)

Large Twin Ensuite Studio -  
2x Single bed (90 x 190cm)

Take a tour of our Twin Ensuite Studio Flat

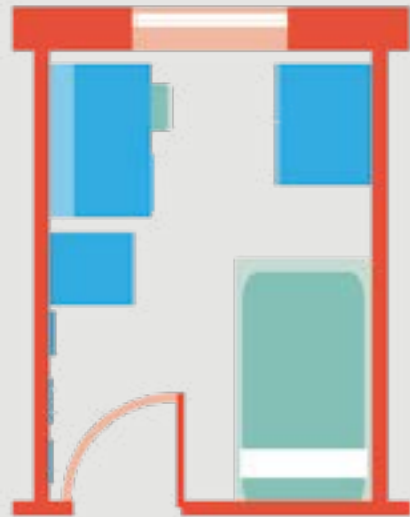

Please note room layouts may vary



Please note room layouts may vary

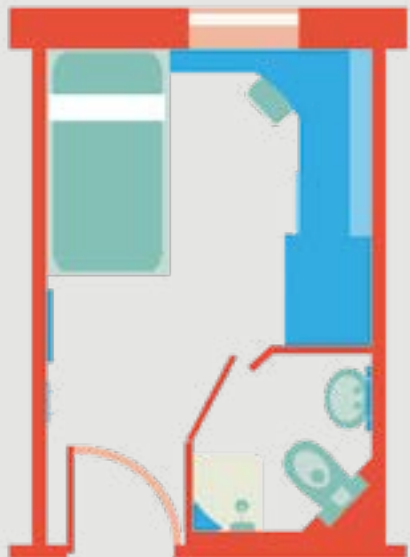

Please note room layouts may vary

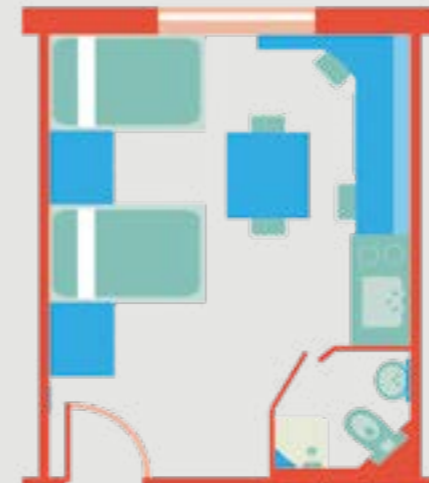

Please note room layouts may vary

# WHAT TO BRING

## BEDDING AND TOWELS

Bed linen (fitted base sheet, duvet, pillows and covers)  
Hand Towel/Bath towel

## COOKING EQUIPMENT

Crockery (plate, bowl, mug and a glass)  
Sauce pan/frying pan  
Baking tray  
Tea towels  
Cutlery and cooking utensils (wooden spoon etc.)

## OTHER ESSENTIALS

Clothes hangers (these are not provided)  
Warm coat, hat, gloves and a scarf  
Umbrella  
Toilet paper

## BEDDING PACKS

Single bedding packs can be ordered online. The pack consists of a hand towel, bath towel, fitted base sheet, duvet, pillow and covers.

Bedding packs  
**£25**

## VIEW OUR WHAT TO BRING VIDEO



# PROHIBITED ITEMS

## ANIMALS

## FAIRY LIGHTS

Unless battery operated

## CANDLES/INCENSE/JOSS STICKS

Or any items with a naked/covered flame

## CHIP PANS & DEEP FAT FRYERS

These are a high risk fire hazard

## CONVECTOR/FAN/HALOGEN HEATERS

Oil filled heaters are authorised

## OVER DOOR HANGERS

Do not use on your room door due to health and safety

## MINI FRIDGES

Medical fridges are available, please contact [BroadgateEnquiries@upp-ltd.com](mailto:BroadgateEnquiries@upp-ltd.com) to arrange, subject to condition

Room visits are carried out twice a year by the Residence Team. If prohibited items are found during visits, this will be raised as a concern and a course of action will be agreed upon.

If you wish to bring a rice cooker please ensure this is kept **ONLY** in your communal kitchen (studio excluded).

The above list is not exhaustive and provided as a guide only. If you have any concerns about an item please contact Reception.

# USING YOUR SPACE SAFELY

## VIEW OUR VIDEO ON SAFE USE OF UK POWER OUTLETS



## PREVENTION MEASURES

For safety reasons, our detection devices are highly sensitive and can be triggered by smoke, excessive steam or even aerosols. Close bathroom doors when showering. Never leave cooking unattended and always ventilate the area with the cooker hood and open windows. Smoking, vaping, naked or covered flames and deep fat frying are not permitted.

## GENERAL SAFETY TIPS

- Don't prop doors open (including fire doors).
- Always carry your keys and keep them safe. Never give your keys to anyone else.
- Be aware of strangers on the premises. If you're not sure who someone is, ask them or alert the staff.
- Always lock your door when you're going out and keep it closed at all times even if you are just nipping to the kitchen/bathroom.
- If you see anything suspicious, report it to staff as soon as possible.
- If your room is at ground level or easily accessible from the ground, make sure your windows are shut before you go out. Windows will only tilt outwards and should not open fully.

# FIRE SAFETY

## WHAT YOU NEED TO KNOW



## IDENTIFY YOUR FIRE ASSEMBLY POINT

(these are displayed in your flat)



IF YOU DISCOVER A FIRE  
DO NOT USE FIRE  
EXTINGUISHERS/BLANKETS.



FIRE  
BLANKET



Close all doors behind you, break the glass on your nearest call point and evacuate the building.

IT'S A CRIMINAL OFFENCE TO TAMPER WITH FIRE EQUIPMENT AND YOU WILL BE FINED FOR MISUSE, AS WELL AS BEING CHARGED FOR REPLACING EQUIPMENT. DO NOT REMOVE THE TAGS FROM THE FIRE EXTINGUISHERS AND DETECTORS MUST NOT BE COVERED UNDER ANY CIRCUMSTANCE.



FIRE DOORS SHOULD REMAIN CLOSED AT ALL TIMES AND SHOULD NOT BE WEDGED OPEN, DOING SO WILL POSE A SERIOUS SECURITY AND FIRE RISK.

SHOULD YOU BECOME AWARE OF A FIRE OR A HAZARD THAT COULD DEVELOP INTO A FIRE, PLEASE CONTACT RECEPTION IMMEDIATELY.



## FIRE ALARM TEST



## EVERY THURSDAY

If alarm sounds for longer than 60 seconds, proceed to your assembly point.

# ONSITE FACILITIES

## LEVEL 1



Level 1 was developed with students in mind creating The Lounge and The Library spaces.

The Lounge allows students to relax and unwind with access to a gaming stations, table football and comfy seating around our projector screen, whilst The Library has study areas for both group and individual work.

Book a space on our Home at Halls app.

## PARKING



Parking permits are available for £300 per year.

Click here to download an application.

Fixed penalty notices of £75 will be applied to non-permit holders or failing to display a permit.

(Parking regulations do not apply during intake)

ALL visitors must report to the Reception.

## LAUNDRY



The Reception laundry and Albion House laundry rooms operate on the circuit laundry app. Our other laundries across the site operate on a cash basis. All laundries are £2 to wash and £1 to dry-exact change is required in the cash operated laundries.

## POST AND PARCELS

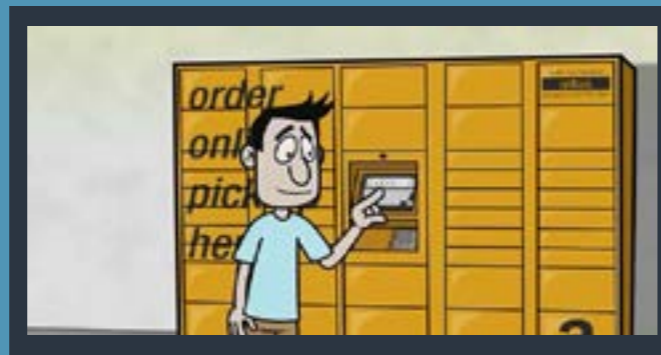

Each flat has a shared mailbox which Royal Mail can access for delivery of letters and small parcels. Always include a contact number for packages so delivery drivers can contact you.

For delivery to our Reception Amazon locker, add 'Vine' to your address book. If the UniDrop multi courier parcel locker has been used for your deliveries you will be notified by text.

# THE LOCAL AREA

## ALBION HOUSE AND BROADGATE PARK

Albion House and Broadgate Park are both located in the lively Nottingham suburb of Beeston. As well as using excellent local facilities you may want to head into the city or find the quickest route to campus. The following links provide a short insight into your local area.

## ALBION HOUSE

## BROADGATE PARK

### SUPERMARKETS

#### Tesco Extra (Beeston) NG9 2WJ

Mon – Sat 6am - 12am

Sun 11am - 5pm

0.4 miles from Albion

0.9 miles from Broadgate

#### Sainsbury's (Beeston) NG9 2LA

Mon – Fri 8am - 10pm

Sat 7am - 10pm

Sun 10am - 4pm

0.1 miles from Albion

0.6 miles from Broadgate

#### Lidl (Beeston) NG9 2NG

Mon – Sat 8am - 10pm

Sun 10am - 4pm

0.1 miles from Albion

0.8 miles from Broadgate

#### Co-op (Beeston) NG9 2GJ

Mon – Sun 7am - 8pm

0.7 miles from Albion

0.2 miles from Broadgate

### TRANSPORT

#### DG Cars

0115 9500 500

[dgcars.co.uk](http://dgcars.co.uk)



Albion House and Broadgate Park are in close proximity to a number of major bus routes heading into the city and Beeston. The tram is also easily accessible.

#### UoN Hopper Buses

[UoN Hopper Bus Information](#)

#### Trent Barton's Indigo service

[trentbarton.co.uk/services/indigo](http://trentbarton.co.uk/services/indigo)

#### Nottingham City Transport's 36 service

[goo.gl/GP0zJe](http://goo.gl/GP0zJe)

#### Nottingham Express Transit's Tram service

[thetram.net/](http://thetram.net/)

# THE LOCAL AREA

## CLOISTER HOUSE

Welcome to Dunkirk, home to Queens Medical Centre, Showcase Cinema and a great student pub, The Johnson Arms. Cloister House is in the heart of this community favoured for pubs, takeaways and the Redfield Way entertainment park. The following link provides a short insight to your local area.

## CLOISTER HOUSE

### SUPERMARKETS

**Tesco Express (Castle Boulevard)**  
NG7 1SA  
Mon – Sun 7am - 11pm  
0.5 miles from Cloister House

**Sainsbury's (Castle Marina)**  
NG7 1GX  
Mon - Sat 7am - 10pm  
Sun 10am - 4pm  
0.9 miles from Cloister House

**SPAR**  
NG7 2JW  
Mon -Sun 6am - 10pm  
0.4 mile from Cloiser House

### TRANSPORT

**DG Cars**  
0115 9500 500  
[dgcars.co.uk](http://dgcars.co.uk)



Cloister House is in close proximity to both the major bus routes and tram line.

**UoN Hopper Buses**  
[UoN Hopper Bus Information](#)

**Trent Barton's Skylink service**  
[trentbarton.co.uk/services/skylinknottingham](http://trentbarton.co.uk/services/skylinknottingham)

**Nottingham City Transport's 34 service**  
[goo.gl/6cajX9](http://goo.gl/6cajX9)

**Nottingham Express Transit's Tram service**  
[thetram.net/](http://thetram.net/)

# USEFUL INFORMATION

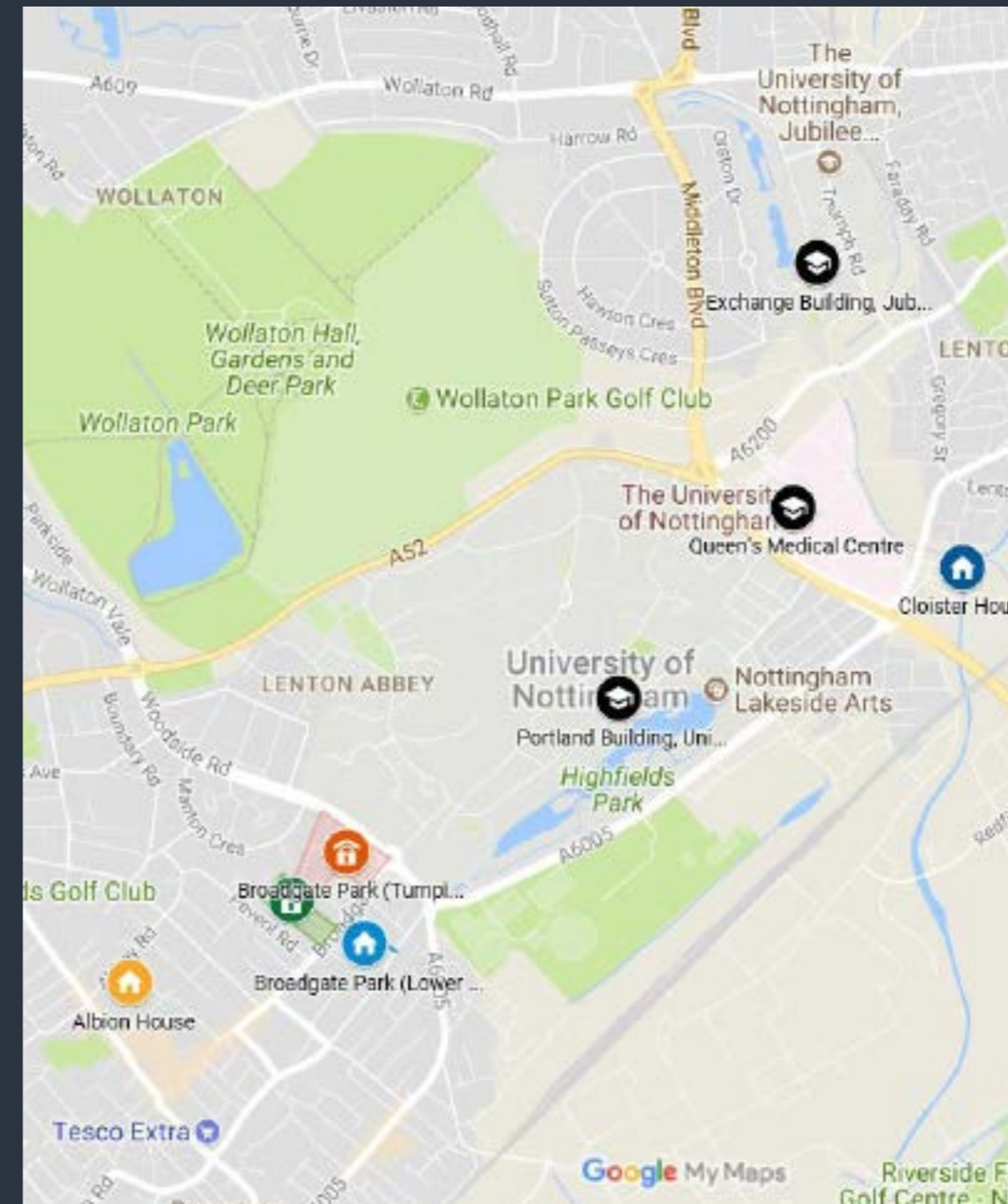

### HOTEL & B&B'S



VIEW SHORT TERM  
ACCOMMODATION  
IN NOTTINGHAM

# OUR MESSAGE TO YOU

We know how important the residential experience is to your time at university and we are working with the University to ensure your accommodation is ready to occupy in September.

Our teams are following the latest Government guidance to protect yourself and others.

Residents are expected to follow government advice on Covid-19.

If any resident develops COVID-19 symptoms, we will ensure the student and their household are supported and have access to the latest Government advice.

If any resident develops Covid-19 symptoms, they must self-isolate and let us know by reporting their status on our Homeathalls APP

[gov.uk/coronavirus](https://www.gov.uk/coronavirus)

[nottingham.ac.uk/coronavirus/](https://www.nottingham.ac.uk/coronavirus/)

Submit  
your room  
inventory

What's  
happening  
at your halls

Download our app



Log a  
maintenance  
issue

Give  
feedback

Follow Us - Search broadgatepark

